

880M Magnetic sideflex chains

- Main application: food and beverage industry , such as transportation of bottles,cans etc.
- Material: POM. Work temperature:-30°C to 90 °C
- Pin mat.:Carbon steel
- Max speed 50m/min lubrication 30m/min dry
- Working load (25°C) 2100N,Max.length 9m

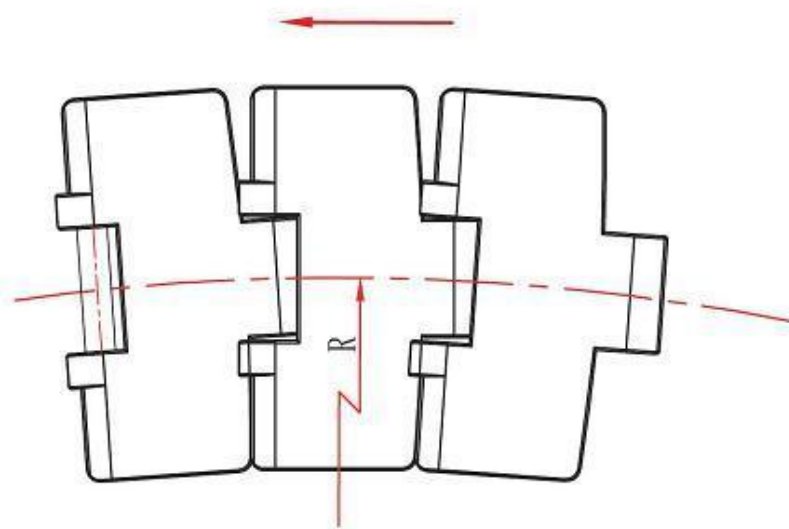

	mm
E	7
G	45
H	15.1
L	7.55
P	38.1
Q	42
T	4

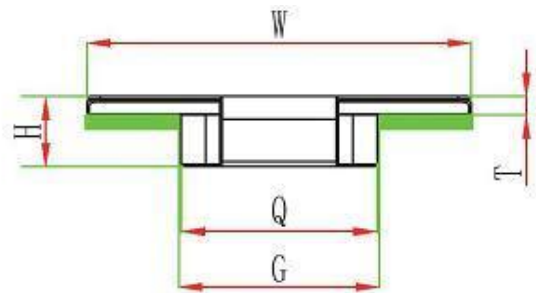
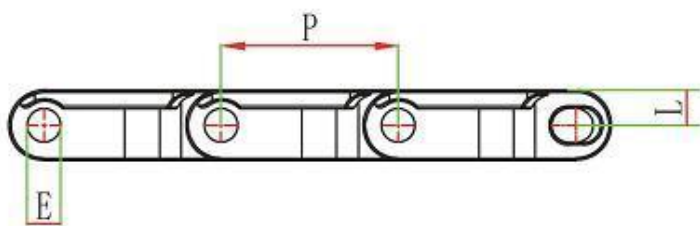

sprocket ref. P37-38



parts ref. P306-332



curve track ref. P336



wear strip ref. P355-359



chain guide ref. P343-354

Code	Width (mm)	Weight (Kg/m)	Backflex radius	Sideflex radius
880M-K325 (P13L)	82.6	1.03	75	500