

882TAB Sideflex chains

- Main application: food and beverage industry, transportation of bottles, cans etc.
- Material: POM. Work temperature: -30°C to 90 °C
- Pin mat.: Stainless steel
- Max speed 50m/min lubrication 30m/min dry
- Working load (25°C) 3830N, Max.length 15m

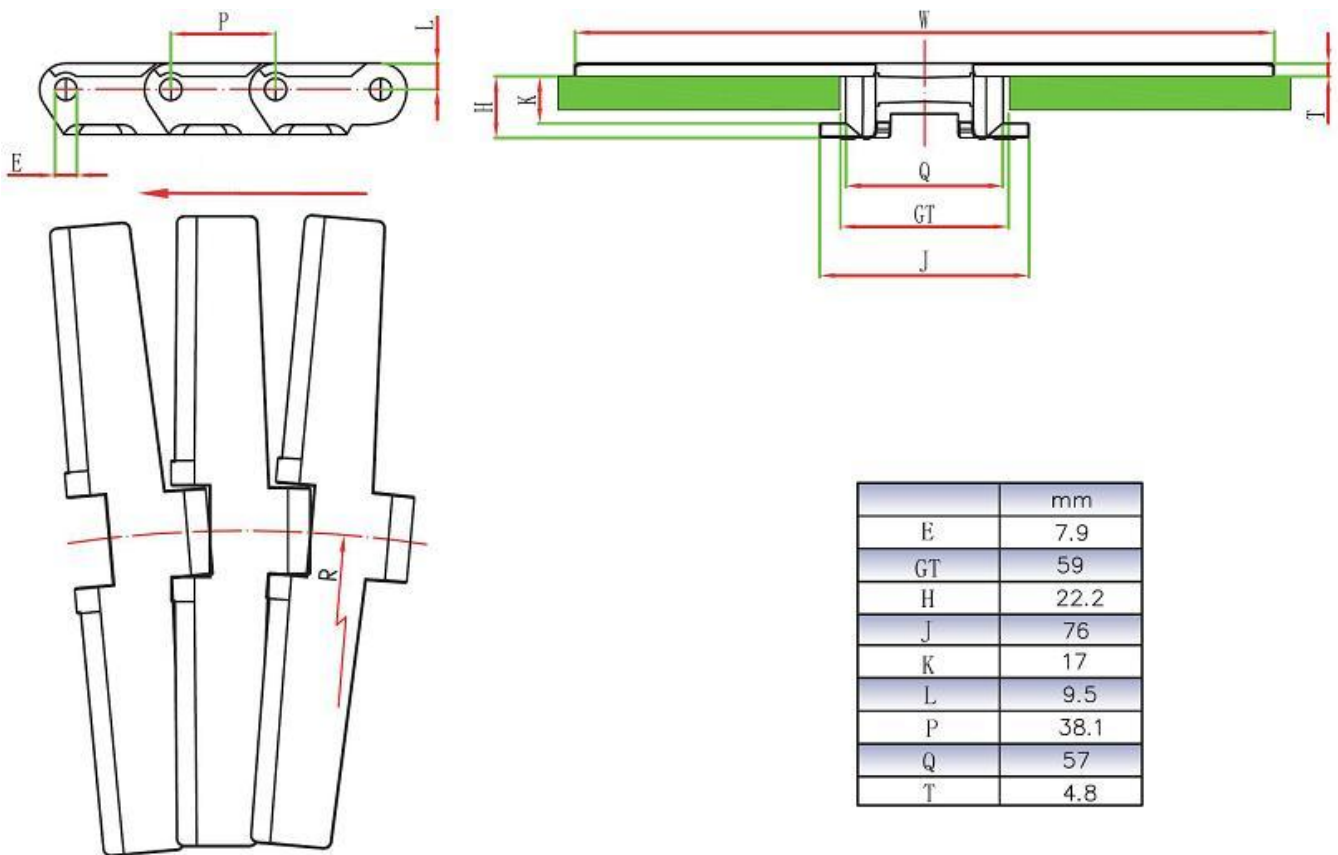

sprocket ref. P40-41



parts ref. P306-332



curve track ref. P334



wear strip ref. P355-359



chain guide ref. P343-354

Code	Width (mm)	Weight (Kg/m)	Backflex radius	Sideflex radius
882TAB-K500 (P10S)	127	1.9	75	610
880TAB-K600 (P20S)	152.4	2.1	75	610
880TAB-K750 (P30S)	190.5	2.38	75	610
880TAB-K1000 (P40S)	254	2.69	75	610
880TAB-K1200 (P50S)	304.8	2.94	75	610

882 Sprockets

- Material: Polyamide PA6, Machined, high precision, matching well
- Bore tolerance: $D^{+0.08}_{+0.02}$
- Good strength, can be used in heavy load transportation

Code	Teeth No	PD (mm)	OD (mm)	Bore (mm)
1-882-10-20	10	123.3	126	20
1-882-10-25				25
1-882-10-30				30
1-882-10-35				35
1-882-10-40				40
1-882-11-20	11	135.2	137.4	20
1-882-11-25				25
1-882-11-30				30
1-882-11-35				35
1-882-11-40				40
1-882-12-20	12	147.2	149.9	20
1-882-12-25				25
1-882-12-30				30
1-882-12-35				35
1-882-12-40				40

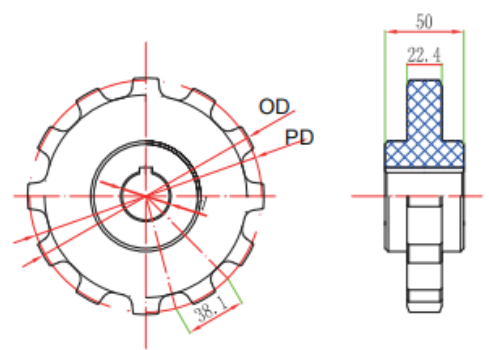

- Material: Reinforced PA, Plastic Moulding
- Bore tolerance: $D^{+0.2}_{+0.1}$

Code	Teeth No	PD (mm)	OD (mm)	Bore (mm)
3-882-10-20	10	123.3	126	20
3-882-10-25				25
3-882-10-30				30
3-882-10-35				35
3-882-10-40				40
3-882-11-20	11	135.2	137.4	20
3-882-11-25				25
3-882-11-30				30
3-882-11-35				35
3-882-11-40				40
3-882-12-20	12	147.2	149.9	20
3-882-12-25				25
3-882-12-30				30
3-882-12-35				35
3-882-12-40				40

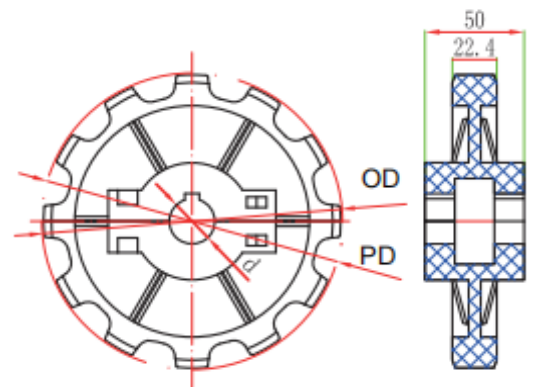

882 Series idler with bearings

- Polyamide PA6, Machined, high precision, matching well
- Good strength, can be used in light load transport
- It can be used for 882 series chain
- The shape and thickness should be machined by Lilai standard
- D1 means bearing outer diameter, Tolerance from -0.05~0, D2
- D2 means bearing inner diameter,
- B means bearing thickness, Tolerance from 0~+0.1;



Model: Process method – Code – Teeth – D₂ – Bearing No.

Example: 2 – 882 – 10 – 25 – 6005

PO NO.: – – – –

① Standard bearing technical parameter

Bearing NO.	D ₁	D ₂	B	d
6003	35	17	10	30
6004	42	20	12	35
6005	47	25	12	40
6205	52	25	15	45
6006	55	30	13	45
6007	62	35	14	50

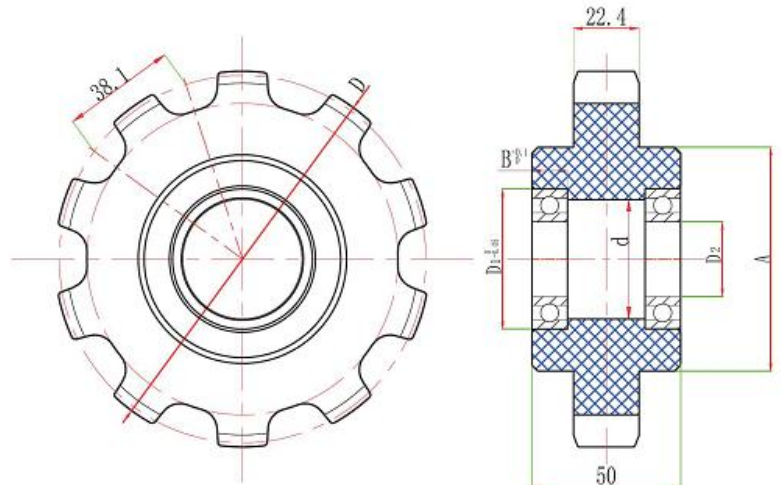

② standard 882TAB idler

Teeth	diameter D	diameter A
9	111.8	65
10	126	75
11	137.4	85
12	149.9	100