

# DJ-100 Modular belt

- Main application: light conveyor such as bottles, boxes and etc
- Material: POM. Color: coffee
- Work temperature: -40°C ~ +90 °C
- Pin material: PP
- Work load: POM,430N/M



sprocket P112



parts P306-332



wear strip P355-359



chain guide P343-354

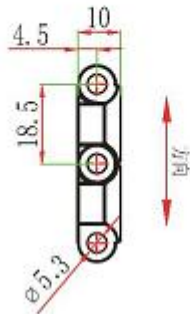
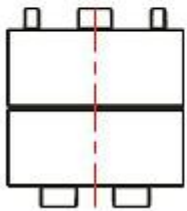
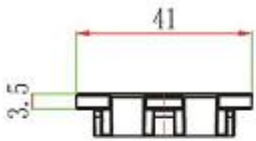

17 链轮行走中心位置

# DJ-100-DB Modular belt

distance between flight

$$K=18.5*N$$

L	W	H	K
	82	28	

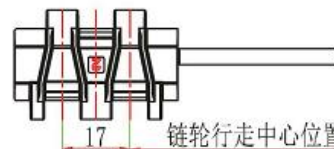
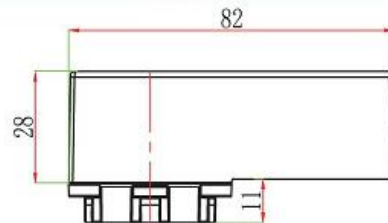
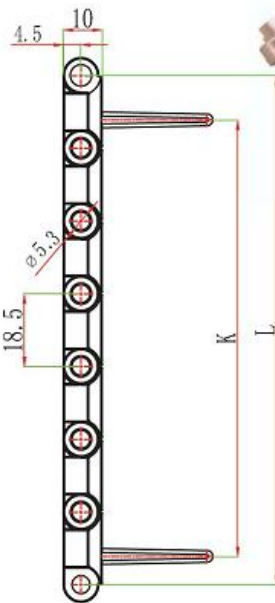
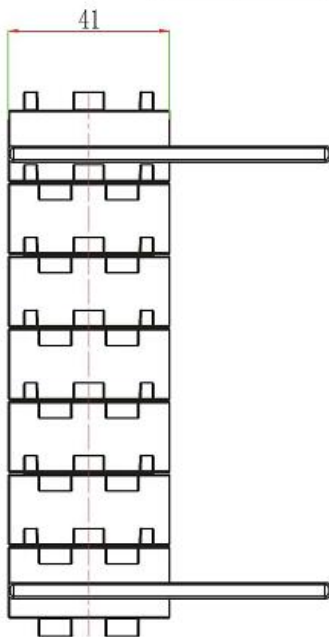

17 链轮行走中心位置

# DJ-100 Sprocket



Raw material: nylon PA6

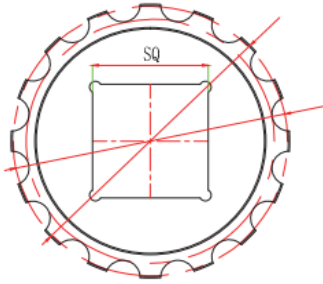

Square bore

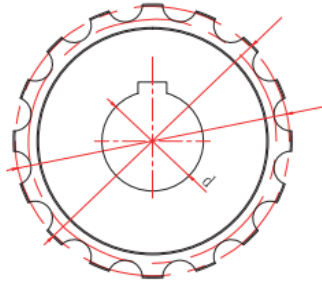

Round bore with keyway

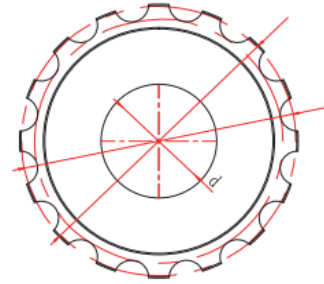

Round bore w/o keyway

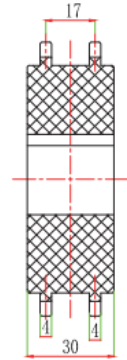

Teeth	Pitch diameter (mm)	Outer diameter (mm)	Bore size (mm)	Sprocket model		
				Square bore	Round bore	
					with keyway	w/o keyway
10	59.87	61.36	20	1-DJ-100-10-20	2-DJ-100-10-20	
			25	1-DJ-100-10-25	2-DJ-100-10-25	
12	71.48	72.98	20	1-DJ-100-12-20	2-DJ-100-12-20	
			25	1-DJ-100-12-25	2-DJ-100-12-25	
			30	1-DJ-100-12-30	2-DJ-100-12-30	
16	94.83	96.32	25	1-DJ-100-16-25	2-DJ-100-16-25	
			30	1-DJ-100-16-30	2-DJ-100-16-30	
			35	1-DJ-100-16-35	2-DJ-100-16-35	
			40	1-DJ-100-16-40X40	1-DJ-100-16-40	2-DJ-100-16-40
20	118.26	119.76	25	1-DJ-100-20-25	2-DJ-100-20-25	
			30	1-DJ-100-20-30	2-DJ-100-20-30	
			35	1-DJ-100-20-35	2-DJ-100-20-35	
			40	1-DJ-100-20-40X40	1-DJ-100-20-40	2-DJ-100-20-40
24	141.73	143.22	25	1-DJ-100-24-25	2-DJ-100-24-25	
			30	1-DJ-100-24-30	2-DJ-100-24-30	
			35	1-DJ-100-24-35	2-DJ-100-24-35	
			40	1-DJ-100-24-40X40	1-DJ-100-24-40	2-DJ-100-24-40

If the bore size below 40mm and the outer diameter above 120mm, the sprocket can be made into split sprocket, such as 1-DJ-100-24-30-HF.