

# T-1900 Modular belt

- Application: Pharmaceutical industry, or packaging machine conveyor
- Material: POM. Work temperature: -30°C ~ +90 °C
- Pin: PP;
- Work load: POM,10500N/M
- Open area: 14%
- Color: blue



sprocket P86



parts P306-332



wear strip P355-359



chain guide P343-354

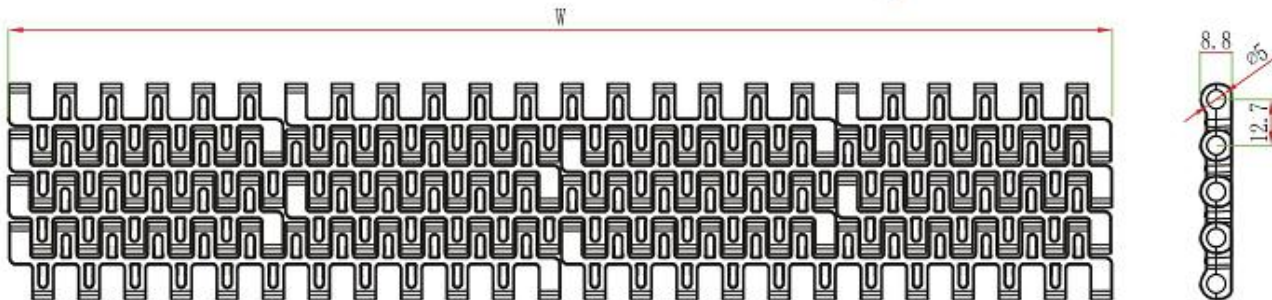

**Standard Width  $W=76.2*N$**

**Non-standard Width  $W=76.2N+12.7*n$**

W (mm)	76.2	152.4	228.6	304.8	381	457.2	533.4	609.6	685.8	76.2*N
--------	------	-------	-------	-------	-----	-------	-------	-------	-------	--------

Remarks: N, n is the multiples of integers, when design or purchase the belt, please contact the sales first to confirm the actual width.

# T-1900 Sprocket

Raw material: PA6

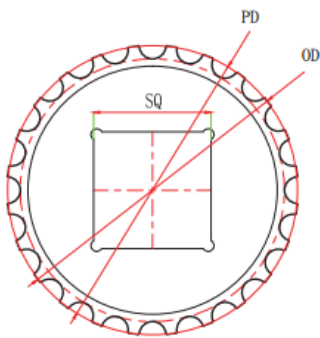

Square Bore

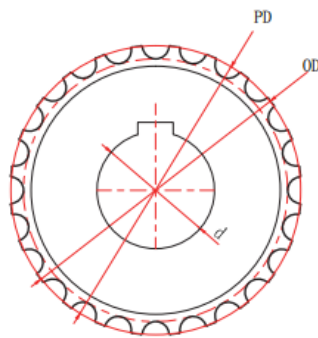

Round bore with keyway

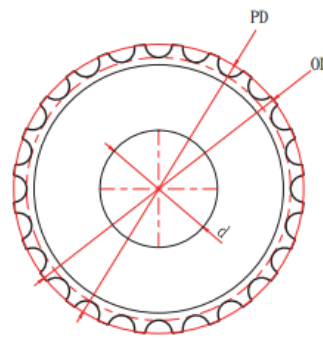

Round Bore  
w/o keyway

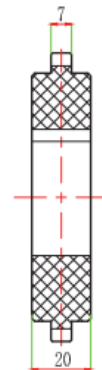

Teeth	Pitch diameter r(mm)	Outer diameter r(mm)	Bore size (mm)	Sprocket model		
				Square bore	Round bore	
					with keyway	w/o keyway
12	49.84	50.5	20	1-T-1900-12-20	2-T-1900-12-20	
			25	1-T-1900-12-25	2-T-1900-12-25	
15	62.05	62.8	20	1-T-1900-15-20	2-T-1900-15-20	
			25	1-T-1900-15-25	2-T-1900-15-25	
			30	1-T-1900-15-30	2-T-1900-15-30	
20	82.46	82.9	25	1-T-1900-20-25	2-T-1900-20-25	
			30	1-T-1900-20-30	2-T-1900-20-30	
			35	1-T-1900-20-35	2-T-1900-20-35	
24	98.83	99.3	25	1-T-1900-24-25	2-T-1900-24-25	
			30	1-T-1900-24-30	2-T-1900-24-30	
			35	1-T-1900-24-35	2-T-1900-24-35	
32	131.61	132	25	1-T-1900-32-25	2-T-1900-32-25	
			30	1-T-1900-32-30	2-T-1900-32-30	
			35	1-T-1900-32-40X40	2-T-1900-32-35	