

T-2600 Modular belt

Main Application: heat shrinkable film, carton conveying and packaging conveying.

Belt material: POM, Working Temperature: $-30^{\circ}\text{C} \sim +90^{\circ}\text{C}$;

Pin material.: PP

Working load: POM 11900N/M;

Open area: 12.5%.

Color: Belt/roller: Dark Green/yellow;

Weight: 7.71kg/sq

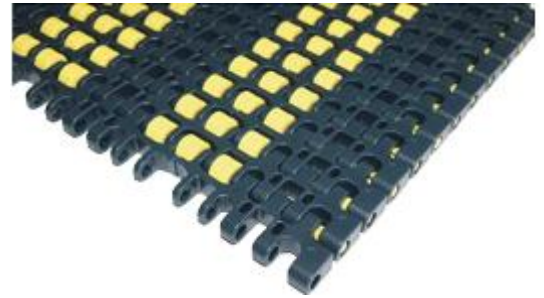

sprocket P109



parts P306-332



wear strip P355-359



chain guide P343-354

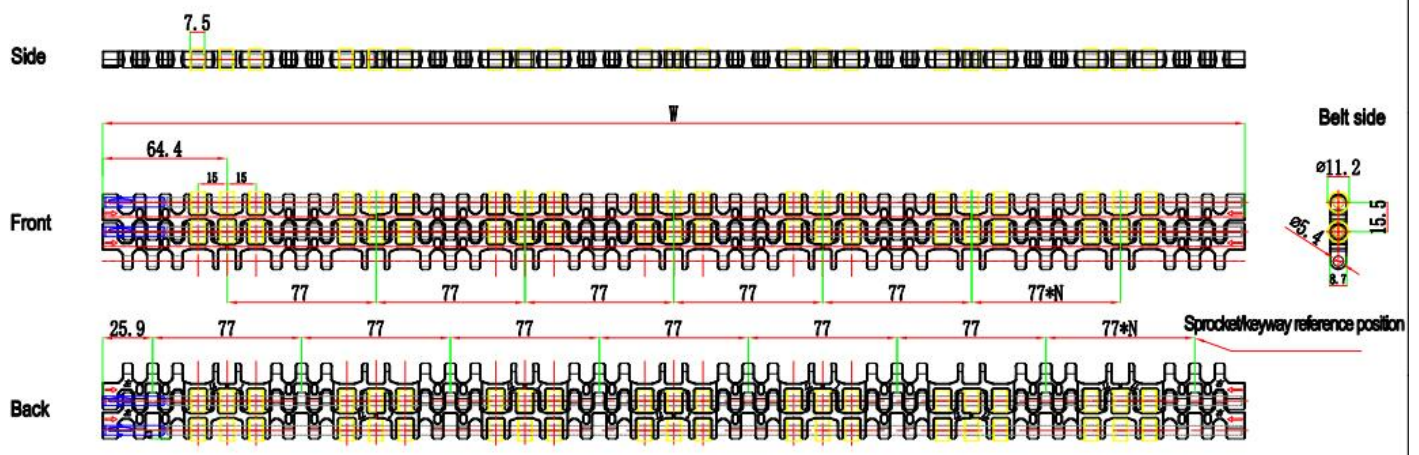

Standard Width: $W=206+77*N$

W (mm)	206	283	360	437	514	591	668	206+77N
--------	-----	-----	-----	-----	-----	-----	-----	---------

Remarks: N, n is the multiples of integers, when design or purchase the belt, please contact the sales first to confirm the actual width.

T-2600 Sprocket

Raw material: Nylon+stainless steel

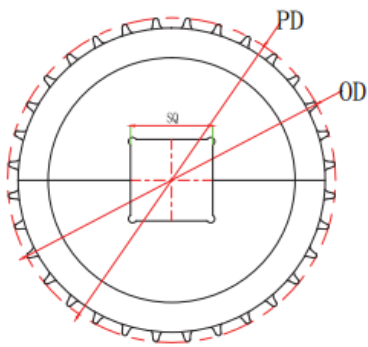

Square bore

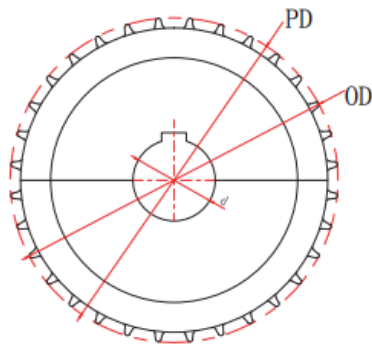

Round bore with keyway

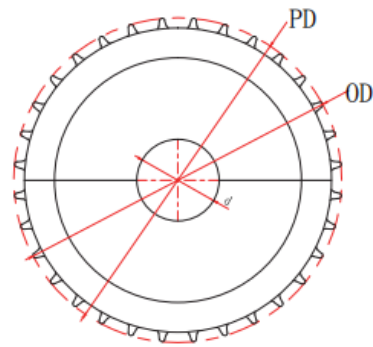

Round bore w/o keyway

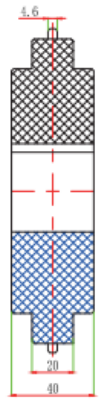

Teeth	Pitch diameter (mm)	Outer diameter (mm)	Bore size (mm)	Sprocket model		
				Round bore		
				Square bore	with keyway	w/o keyway
16	79.4	80.7	20		1-T-2600-16-20-HF	2-T-2600-16-20-HF
			25		1-T-2600-16-25-HF	2-T-2600-16-25-HF
24	118.7	120	25		1-T-2600-24-25-HF	2-T-2600-24-25-HF
			30		1-T-2600-24-30-HF	2-T-2600-24-30-HF
			35		1-T-2600-24-35-HF	2-T-2600-24-35-HF
			40	1-T-2600-24-40X40-HF	1-T-2600-24-40-HF	2-T-2600-24-40-HF
32	158.1	159.4	25		1-T-2600-32-25-HF	2-T-2600-32-25-HF
			30		1-T-2600-32-30-HF	2-T-2600-32-30-HF
			35		1-T-2600-32-35-HF	2-T-2600-32-35-HF
			40	1-T-2600-32-40X40-HF	1-T-2600-32-40-HF	2-T-2600-32-40-HF

HF means split sprocket